

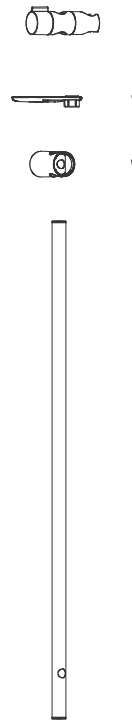

1. Drill two ϕ 6mm holes (spacing less than 500mm and 30mm deep) on the wall, and put the wall plug into the hole.



2. Put the screw into the screw hole of the upper wall support, align with the wall plug hole, and lock the screw.



3. Put the down wall support assembly, soap dish and the central part into the stainless steel tube in turn according to the direction shown.

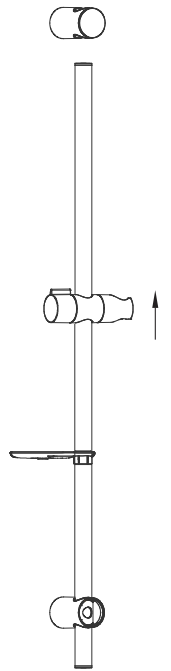

4. Put the stainless steel tube assembly from bottom to top into the upper wall support.

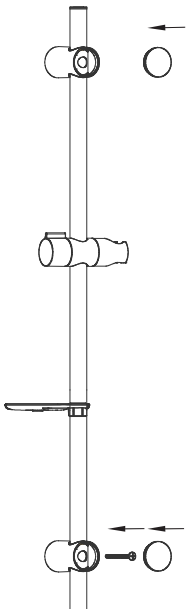

5. Adjust the position of the down wall support so that the wall plug hole, the wall support screw hole and the steel pipe hole are located in the same straight line, lock with the screw, and put the upper and down decorative cover into the wall support respectively.

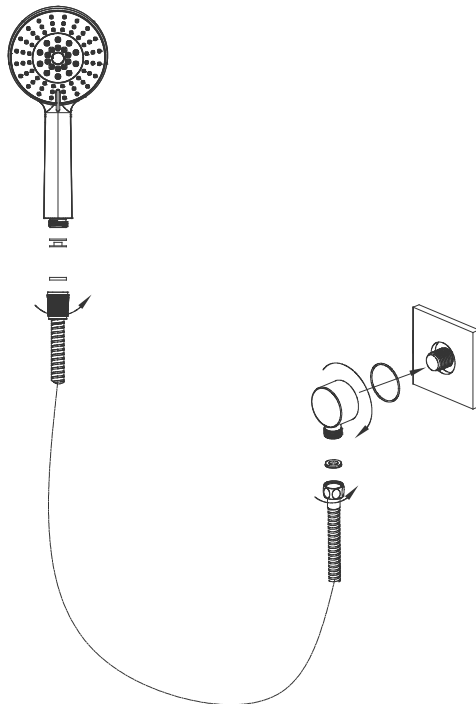

6. Screw the water inlet elbow into the outlet end, ensure the O-ring is to create a watertight seal. Take out the hose, screw one end of the hex nut into the water inlet elbow joint, make sure rubber seal with stainless steel filter exist. Screw the other end into the shower thread joint, make sure rubber seal rings and flow restrictor installed.

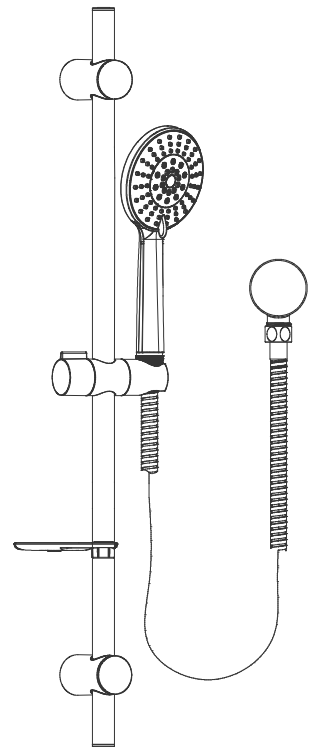

7. Install the shower onto the central part and the installation is complete.