

INSTALLATION INSTRUCTIONS DEADBOLT LOCKSET

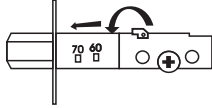

Your Latch is factory set for 2-3/8" (60mm)
If your door requires a 2-3/4"(70mm)Latch,
follow these steps.

A. Hold Latch in your right hand so you can
see adjustment holes. With left hand turn
latchplate in clockwise position. pull latch
plate out of sase as far as it will go.

B. Turn back and lock into 70mm position.

3.INSTALL INTERIOR ASSEMBLY

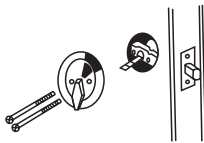

Make sure Deadbolt is in Locked position.
Place thumb turn assembly onto torque blade and line
up screw holes. The thumb knob will be in the "up"
position so you can see the screwholes. Tighten long
machine screws.

1. INSTALL THE LATCH

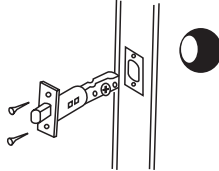

1. Install deadbolt latch in "up" position into
door hole.
2. Insert and secure with wood screws.

2.INSTALL EXTERIOR ASSEMBLY

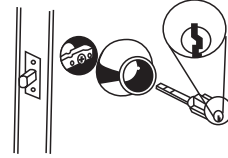

1. Place cylinder assembly through outside cylinder
guard and on door making sure torque blade is
properly positioned in latch crank.
2. Put key in cylinder and turn until Deadbolt is exposed.
Note: Keyhole must be in the "down" position as shown.

INSTRUCTIONS FOR INSTALLING DOUBLE CYLINDER DEADBOLTS

Install Exterior Cylinder

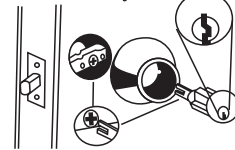

Press interior assembly flush against door making
certain the torque blade is properly positioned in
the latch hole. Key hole must be in down position.

Install Interior Cylinder

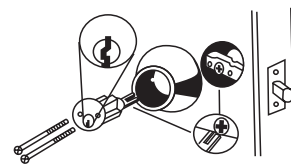

Insert (2) two screws through holes engaging holes in
exterior cylinder and tighten.

INSTALLATION TEMPLATE

